



David Henry Hwang Theatre
 120 Judge John Aiso
 Los Angeles, CA 90012
 (213) 625-7000
www.eastwestplayers.org

General Theatre Information

Seating Capacity

Orchestra, general	167
ADA and companion seats	6
Balcony	63
Total	236

- Seating has no aisles in the middle
- There is no cross over in the back of the Orchestra level
- Orchestra is located on the 2nd floor of the building
- Balcony is located on the 3rd floor of the building
- Elevator access to Orchestra level only
- Bathrooms are located on the ground floor and 3rd floor
- Seating chart is located on page 6

Stage Dimensions

Down Stage of Proscenium	
Width	34'
Depth.....	12' (subject to change)
Up Stage of Proscenium	
Width	19'
Depth	10'
Height.....	19' at top of arch

Ground plan is located on page 7

Loading

- Stage is located on 2nd floor of building
- Utility Elevator going to all 4 floors, located at the back of the building
 - Elevator door: 3' wide x 7' tall
 - Elevator interior: 5'4" wide x 4' deep x 7'5" tall

- Stairs going to all 4 floors, located at the back of the building
- Door into the stage is 3'4" wide x 6'6" tall
- Stage is built up 3' from the building floor
- There is no ramp or elevator onto the stage itself
- Three (3) cars can park next to the building to load and unload
- Chain Hoist located on 2nd floor for heavy lifting

Backstage

- Decking level with the stage height
- Decking is 8'9" deep x 16' wide x 6' tall to ceiling
- Paint sink
- Various height A-frame ladders

Fly System

- 18 total pipes
- 5 designated electrics with raceway runs
- NOT a full fly, no live flies
- 10 pipes are run by hand drive system
- 8 pipes are run by push buttons on stage

Soft goods/curtain package

- Available upon request
- Extra time may be required to hang

Pianos

(please call for availability and pricing)

- Black Baby Grand, Baldwin
- Wooden Upright, Yamaha

Projector

- (1) NEC NP4000
- (1) Front Projection Screen Size 10' h x 14' w
- (1) Rear Projection Screen size 10' h x 14' w

Dressing Rooms (located on 3rd floor)

- Dressing Room A
 - 6 stations
 - Bathroom with sink, toilet and handicap accessible shower
- Dressing Room B
 - 10 stations
 - Bathroom with sink, toilet and handicap accessible shower

Hospitality Station

- Located in the back hallway behind the stage
- Mini fridge, microwave, water cooler, coffee maker

Lighting System

Rep plot available upon request

Console

- ETC Ion 1024 with 2 x 24 Fader Wings

Dimmers

- 196 dimmer capacity

Instrument Type Count (Inventory subject to change)

- (35) S4 PAR
 - Full complement of lenses
- (87) S4 Ellipse Body
 - Full complement of lens tubs
- (4) Far Cyc 1k 3 cell
- (2) Elation Design Spot 300
- (2) Rosco i-cue
- (2) Apollo EZ Iris DMX
- (2) Gobo Rotator
- (12) ETC D40 VIVIS 7 Color Mix
 - (12) Medium Linear Lens
 - (12) Wide Round Lens
- (8) Stik-up 300w

Accessories (Inventory subject to change)

- (9) Drop-In Irises
- (1) MDG Hazer
- (1) Mirror Ball with Motor
- Misc. Gobos, inventory available upon request

Sound System

Mix Position

- Located in the back of the balcony, house right.

Console

- Midas M32

Speakers

- Main: (3) Apogee ACS-4B
- Sub: (1) Apogee ACS 118
- Balcony: (3) JBL

Playback Devices

- Q Lab

Microphones

- Inventory available upon request

DI's

- (2) Mono Whirlwind Director
- (3) Mono CBI Performance Series
- (1) Stereo Radial PRO AV2

Mic Stands

- (3) Table Stands
- (3) Tall Tripod Boom Stands
- (2) Short Tripod Boom Stands
- (1) Kick Mic Stand
- (6) Round Base Boom Stands
- (2) Round Base Straight Stands

Intercom

- Wired intercoms are set up in the following areas:
 - Tech Booth
 - Back stage right in alcove
 - Back stage left in hallway

Seating Chart

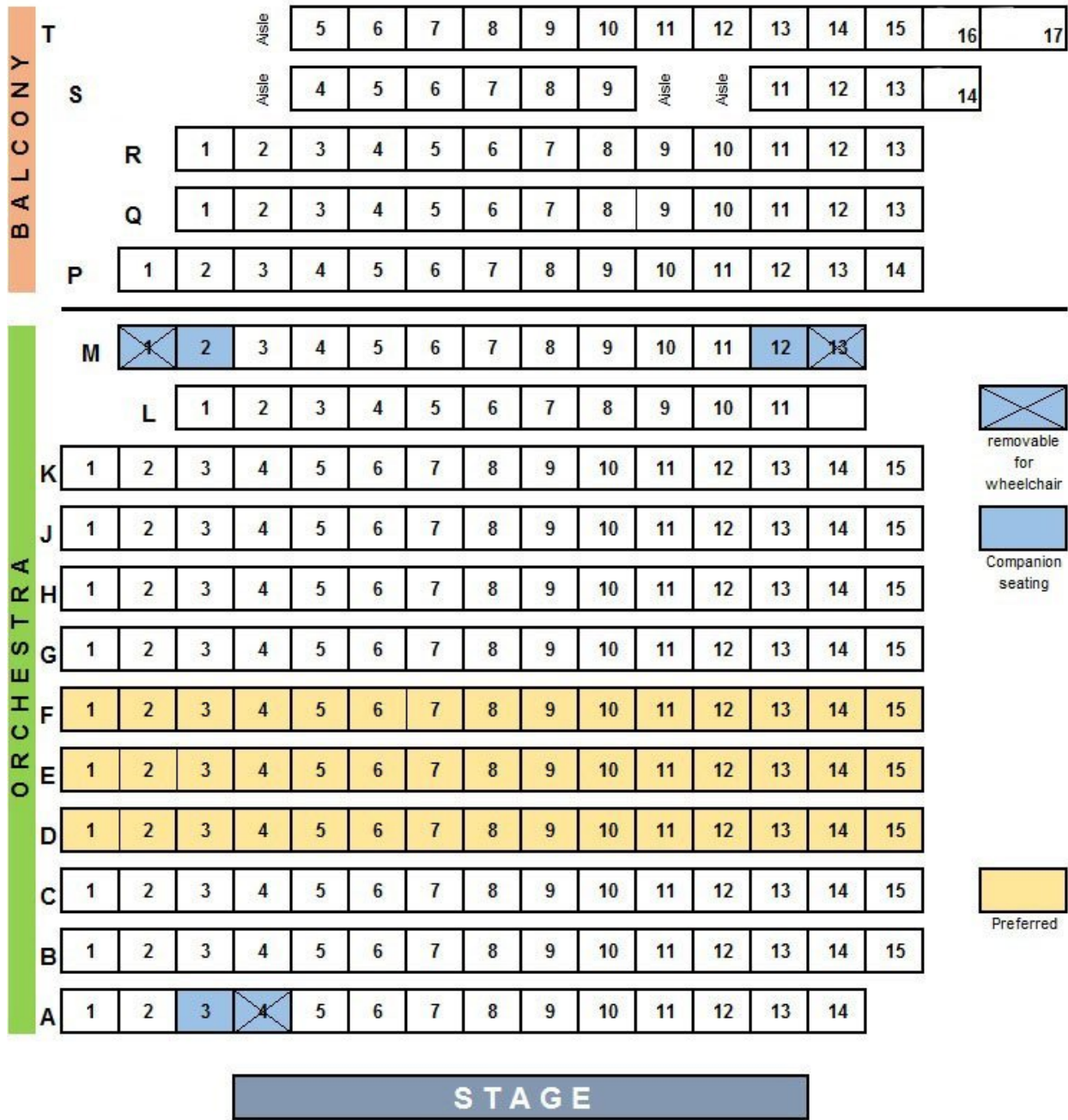

Seating Capacity

Orchestra, general	167
ADA and companion seats	6
Balcony	63
Total	236

Theatre Ground Plan

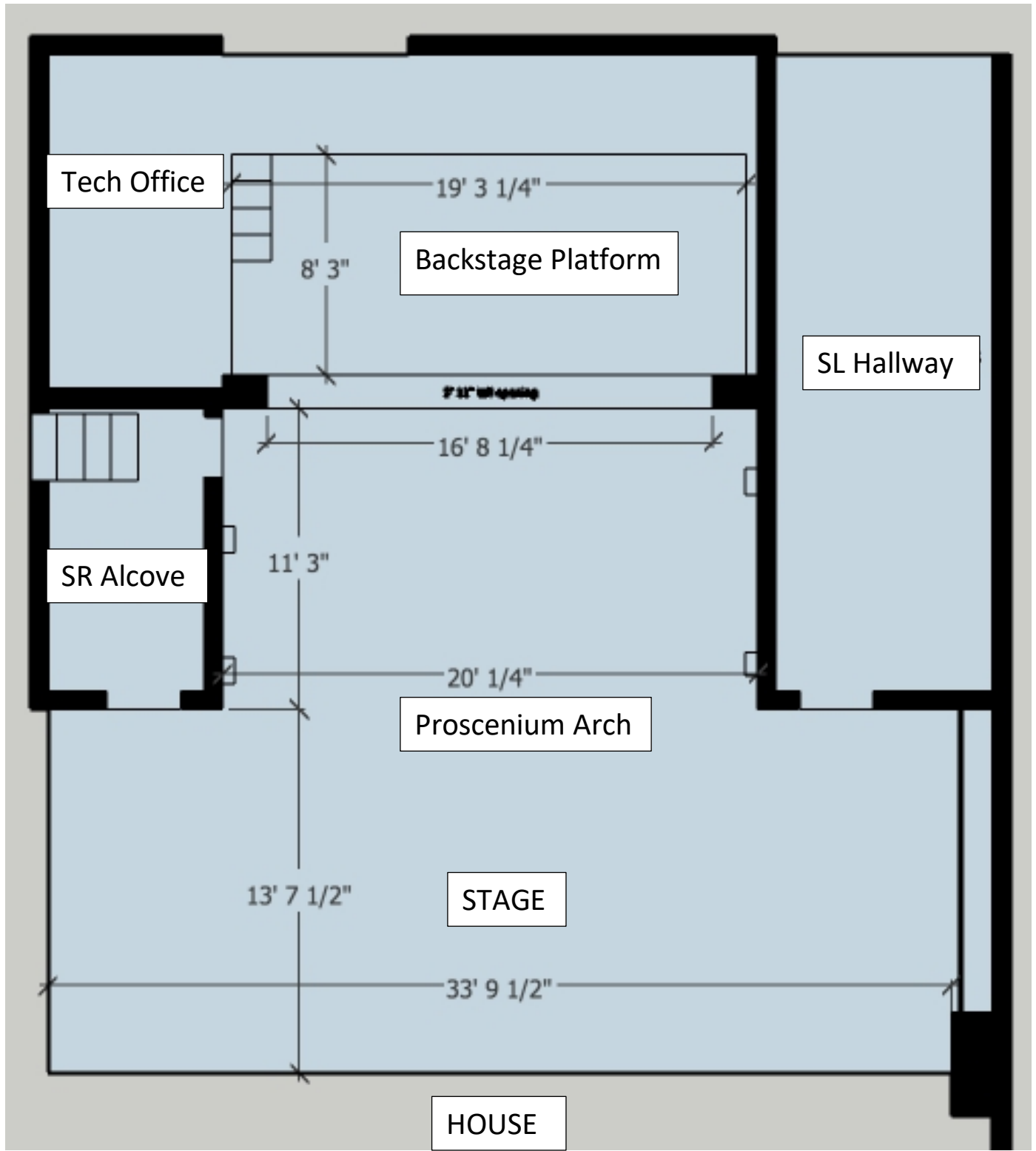

Metro

The theatre is accessible by the Metro!

Exit the Metro Gold Line at the Little Tokyo/Arts District Station (0.3 miles)

- Walk South to East 1st Street
- Cross N. Alameda Street
- Turn right on Judge John Aiso Street
- The theatre will be on your right

Exit the Metro Red Line at the Union Station (0.6 miles)

- Exit the front of Union Station, towards N. Alameda Street
- Turn left on N. Alameda Street
- Turn Right on E. Temple Street
- Turn Left on Judge John Aiso Street
- The theatre will be on your left

Driving Directions

West Los Angeles/Santa Monica

- Take the 10 Freeway east to 110 Freeway North.
- Take 101 Freeway South
- Exit Los Angeles Street
- Turn Left onto Temple Street
- Turn Right on N. Judge John Aiso Street
- Building is on the left

San Gabriel Valley/ Glendale

- Take 10 Freeway west to 101 Freeway North
- Exit Alameda/Union Station
- Turn left onto Alameda Street
- Turn Right onto Temple Street
- Turn left onto N. Judge John Aiso Street
- Building is on the left

San Fernando Valley

- Take the 5 freeway South to the 11 Freeway South
- Exit on Hill Street
- Follow it north through Chinatown
- Turn left on Temple Street
- Turn right on N. Judge John Aiso
- Building is on the left

Pasadena

- Take the 110 Freeway South
- Exit on Hill Street
- Follow it North through Chinatown
- Turn left on Temple Street
- Turn right on N. Judge John Aiso
- Building is on the left

Santa Ana/Orange County

- Take the 5 freeway North to the 101 Freeway North
- Exit Alameda/Union Station
- Turn left onto Alameda Street
- Turn Right onto Temple Street
- Turn left onto N. Judge John Aiso Street
- Building is on the left

Parking

